

Window Ideas

By Pete Gamet, Greenleaf Designs

Window ideas are the most ask question I get asked about. The answer is to keep it simple. When you build the blind, you have scrap material left over and you also have the cutouts for the window openings. Save the material and use it.

The things that you will need for the windows are,

- The window cutouts (mark them as to what window they came from)
- 2 inch strips of scrap plywood or OSB
- 2 or 3 hinges per window
- Window latch or some hook & eye screws (to keep the window closed)
- 3/4 inch screws
- Nuts and bolts for the hinges

Some optional things that you want to consider,

- Nylon Camo screen
- Plexiglas (instead of the wood)
- Staples or Velcro for the screen
- Braces (I will explain later)

Now that you have the material needed to create your windows, time to put them together.

Step One.

Trim around the outside of the window with the 2 inch strips. You can cut them however you want. Cut them on an angle like a picture frame or square them up. Either way, you want them to be 1 1/2 inches longer than the opening. You also want to overhang the opening 1/2 inch. This is so the window has something to rest against when it is closed. It also serves another purpose, which is optional and will get into that later.

Step Two.

After the window is trimmed, lay the window cutout inside the opening. Center it using any material that is the thickness of a saw blade. Place the hinges how you want the window to open and fasten them. I place the hinges on the bottom if it is a horizontal window and on the side if it is vertical.

Step Three.

If you have hook and eye screws, now is the time to place them where you want them. The same goes if you are using latches. Fasten them down and test how the window opens and closes. It should open and close quietly and smoothly.

This is the easiest and the simplest way to create windows for your hunting blind. Face it they don't have to be pretty, just functional. The only time you really need them is when you are sitting in it hunting and you want to keep the bugs out of your blind.

Options

From what I have tried and found out is that window screen works wonders. It not only keeps out the bugs when the windows are open but if you use the Nylon Camo screen, you can shot through it with your bow. I don't recommend doing that with a firearm.

To add a screen to the window is easy.

1. Take the cutout and use as a pattern. Trace the outline onto the screen and cut it out.
2. Place the screen inside the opening, up against the trim lip that is overhanging the opening.
3. Using Velcro or staples, fasten the screen to the trim. For the firearm hunters, I recommend using Velcro, that way you can remove the screen when needed.
4. Do the same for the rest of the windows.

Store the left over screen in a safe place for future use. You can always replace the screen as needed when ever you like, or you can make extra as you are making the ones for the windows.

Some want a see-thru window that doesn't need to be opened all the time. You can use Plexiglas instead of the wood cutouts. Use the cutouts as template and trim as needed. Follow the steps for the windows as above and use Plexiglas in place of.

Braces

This is something for the firearm hunters. I know how a good shooting rest can make the difference. Well add a brace under the window and make it into a shelf or rest. The brace can be anything that will hold the cutout at 90 degrees when opened and strong enough to hold the weight of the firearm and your hand.

The easiest way I found is to cut a triangle from scrap plywood. The triangle should look like a 30-60 degree triangle. For those not familiar with geometry, it is longer than it is wide. Use a couple of hinges so it can be swung out of the way when not needed and add a stopper to the window cutout, so it stays put when in use.

Now you have a simple window that works.

For those that would like them, I have added some drawings.

WINDOW IDEAS

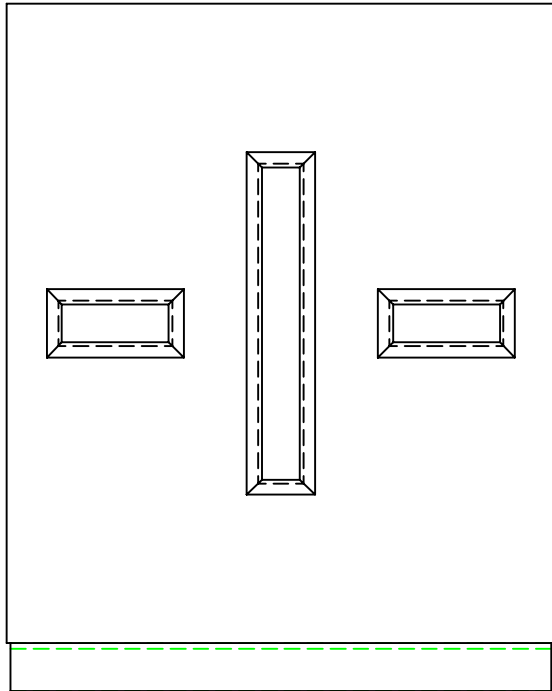

INDEX	#
COVER	1
MATERIALS NEEDED	2
CUTOUTS	3
TRIM DETAILS	4
BRACES	5

PLEASE NOTE THAT NOT ALL BLINDS USE THIS WINDOW CONFIGURATION. THIS FOR GRAPHICAL PURPOSES ONLY.

MATERIALS NEEDED

1. WINDOW CUTOUTS FROM BLIND
2. 2 INCH STRIPS FOR OUTSIDE FRAME
3. HINGES
4. HOOK AND EYE SCREWS OR LATCH
(SOMETHING TO KEEP THE WINDOW CLOSED)
5. OPTIONAL; WINDOW SCREEN
6. OPTIONAL: PLEXYGLASS

GREENLEAF DESIGNS

7455 GILBERT RD. CASS CITY, MI 48726

PROJECT NAME:

WINDOWS

DRAWING TITLE:

MATERIAL NEEDED

PROJECT NO.

DETAIL

DRAWING NO.

2

DRAWN BY:

PETE GAMET

SCALE:

NONE

DATE:

11/01/2006

WINDOW CUTOUTS

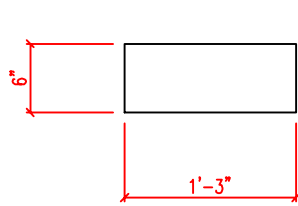

HORIZONTAL WINDOW CUTOUT

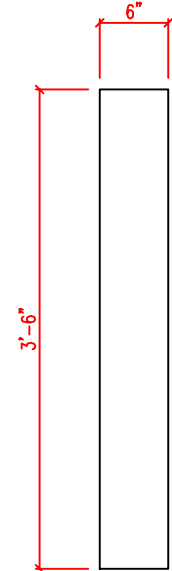

VERTICAL WINDOW CUTOUT

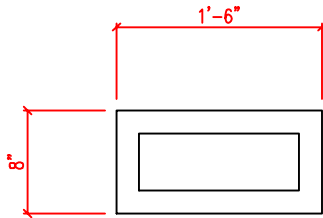

HORIZONTAL WINDOW FRAME

NOTE: THE FRAME GOES ON THE OUTSIDE OF THE BLIND. OVERLAP THE OPENING 1/2 INCH.

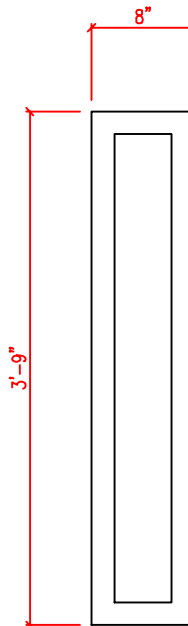

VERTICAL WINDOW FRAME

NOTE: THE FRAME GOES ON THE OUTSIDE OF THE BLIND. OVERLAP THE OPENING 1/2 INCH.

TRIM DETAIL

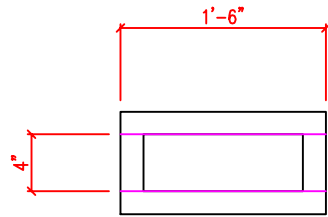

OR

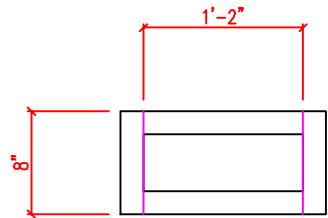

OR

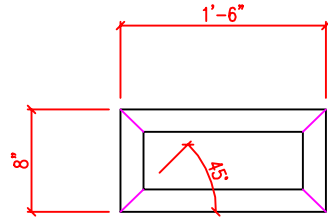

HORIZONTAL WINDOW FRAME

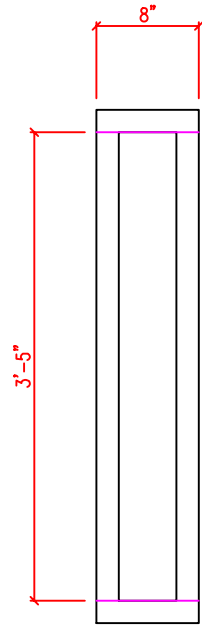

OR

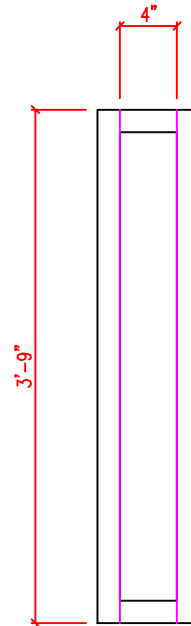

OR

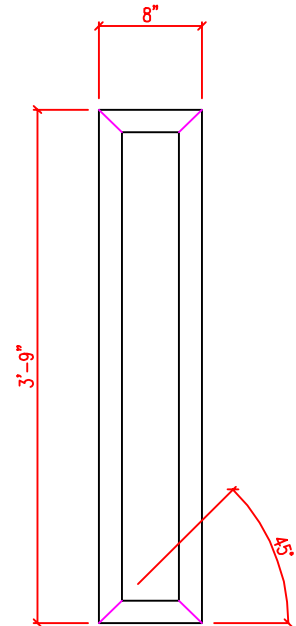

VERTICAL WINDOW FRAME

NOTE: IT DOESN'T MATTER HOW YOU CUT THEM, AS LONG AS THEY ARE 2 INCHES WIDE.

